



Old Ford Road, London, E3

BUTLER  STAG



Gorgeous two bedroom warehouse conversion apartment a stone's throw from Victoria Park, the canal and the amenities of trendy Bow.



- Gorgeous Two Bedroom Apartment
- Full of Character
- Victoria Park Location
- Part Furnished
- Warehouse Conversion
- Open-Plan Kitchen/Living
- Amenities of Roman Road Nearby
- Available from 19th July 2025

Featuring high ceilings, exposed brick walls and large factory-style windows that flood the space with light, the property offers a unique blend of contemporary living and industrial charm, preserving the character of its industrial heritage.

Comprising of a wonderful and spacious open-plan kitchen / reception with breakfast bar and plenty of space for living and dining, both bedrooms are comfortable doubles, providing ample space to relax and work from home if needed. The apartment is completed by a modern tiled bathroom and hallway storage.

Connaught Works offers residents access to a range of amenities, including a communal courtyard, secure entry system and bike storage.

The location is also second to none, being situated just moments from the ever-popular Victoria Park and the amenities of the historic Roman Road, including artisan cafes and coffee shops. Walks, runs and bike rides along the serene Hertford Union Canal are on your doorstep. Local stations are easily reachable too and the bus links into Shoreditch and the City are excellent.

Perfectly suited to a couple or two professional sharers, this must-see apartment is offered part furnished and available from 19th July 2025.

EPC Rating D
Council Tax Band C





Connaught Works

Approx. Gross Internal Area 56 sq. metres (602.4 sq. feet)

BUTLER & STAG

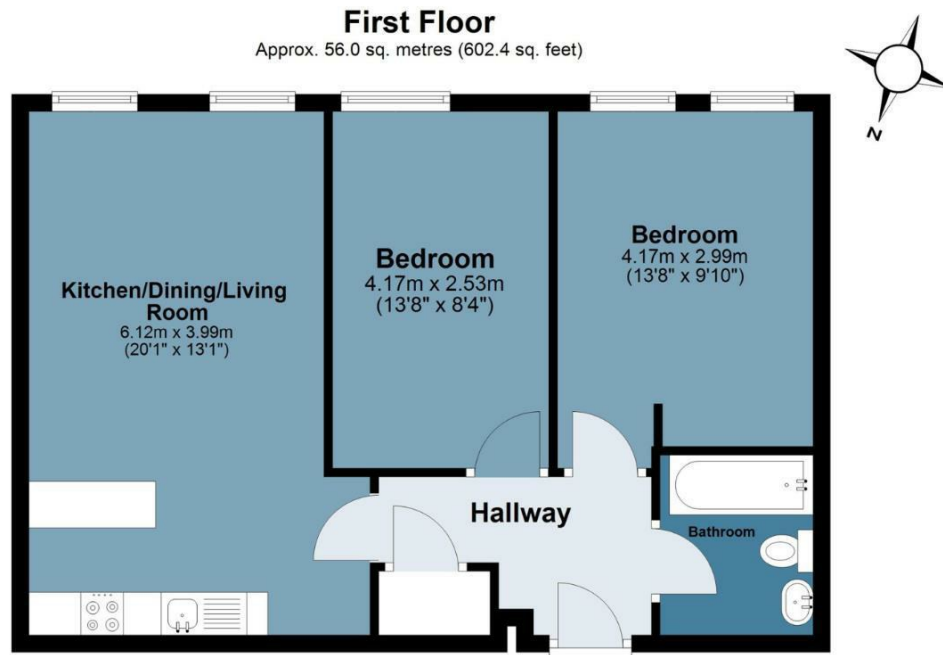

Measurements are approximate and for illustration purposes only. While we do not doubt the accuracy and completeness, we advise you conduct a careful independent assessment of the property to determine monetary value
© @modephoto.uk www.modephoto.co.uk

IMPORTANT NOTICE - These particulars have been prepared in good faith and they are not intended to constitute part of an offer or contract. We have not performed a structural survey on this property and the services, appliances and specific fittings have not been tested. All photographs, measurements, floor plans and distances referred to are given as a guide and should not be relied upon.

BUTLER & STAG

☎ 020 8102 1236

🏠 508 Roman Road, Bow, London, E3 5LU

✉ bow@butlerandstag.com

www.butlerandstag.uk